

CATALOGUE 2020

DOMETIC CARE

DOMETIC REFRIGERATORS AND SAFES
FOR HEALTH AND CARE FACILITIES

 **DOMETIC**



MEDICAL & FOOD

For safe storage of temperature sensitive medicines and patient food in retirement homes and hospitals.

PAGE 8 – 17



SAFETY & SECURITY

Dometic ProSafe – Advanced technology for safe and secure storage of valuables

PAGE 18 – 25



INTRODUCTION

ABOUT DOMETIC

4 – 5

MEDICAL & FOOD

DOMETIC MEDICAL REFRIGERATORS

8 – 13

Dometic DS absorption refrigerators

9

Dometic HC compressor refrigerators

10 – 11

Dometic MC 302 breast milk refrigerator

12 – 13

DOMETIC FOOD REFRIGERATORS

14 – 15

Dometic Silencio Food Line
absorption refrigerators

14 – 15

Ventilation instructions

16

Dometic CoolFreeze CFX compressor coolers

17

SAFETY & SECURITY

DOMETIC PROSAFE ROOM SAFES

18 – 19

Dometic ProSafe Premium Class room safes

20 – 23

Dometic ProSafe Standard Class room safes

24 – 29

DOMETIC ON THE WEB

Here's where you can find the complete Dometic range, with detailed information about all products. Plus, interesting facts about our company and download links for all our catalogues.

www.dometic.com/care

WELL PROVEN FOR DECADES

DOMETIC REFRIGERATORS AND SAFES FOR HEALTH AND CARE FACILITIES

Dometic is a leading manufacturer of cooling appliances for special applications – with decades of experience in the healthcare sector. Our reference list includes hospitals, retirement and nursing homes, doctor's surgeries, pharmacies and laboratories.

Dometic Medical and Food Line refrigerators have been proven thousands of times over, across Europe and beyond. They are among the most compact of their kind available in the market. With its ProSafe range, Dometic also provides a reliable solution for secure storage of the patients' or residents' valuables.

All products for the healthcare sector are manufactured to stringent quality and environmental standards in Dometic's, certified factories. Our sales and service network spans almost 100 countries and provides personal support to customers and planners on all continents.

RESPONSIBILITY FOR THE ENVIRONMENT

At Dometic, thinking and acting ecologically is an all-embracing process that extends to all levels – from the design of resource-saving, energy-efficient products to sustainable production processes and special recycling measures. You can be 100% sure that all applicable regulations, directives and guidelines are fulfilled.

CERTIFIED QUALITY

- All Dometic production plants are certified according to ISO 9001 and ISO 14001 as well as the Eco-Management and Audit Scheme.
- Dometic is an EMAS-certified company. All environmental results are published in Dometic Environmental Product Declarations.
- All products fulfil the requirements of the European Union's ROHS directive.



Dometic's certified production facility at Jászberény, Hungary



DOMETIC PRODUCTS VALUE PROPOSAL

FOR HOSPITALS, RETIREMENT HOMES, SURGERIES AND PHARMACIES

HOSPITALS & CLINICS

Having their own Food Line fridge and ProSafe in the room gives patients peace of mind and comfort while away from home. They are less dependent on staff for drinks and food and can rest assured that their valuables are safely stored. This, in turn, relieves the staff and cuts on operating costs. Hotel-like amenities can also help hospitals and clinics stand out from their competitors. Medical refrigerators on the station floor provide easy access to daily medications and common prescriptions, which means shorter distances to go for the hospital staff.

Product examples: DS 400, HC 302 DIN, DS 301 H and MD 363

RETIREMENT HOMES

Dometic Food Line refrigerators take up very little space and offer a great deal of comfort. They make the residents feel more at home, and more independent too. This relieves the nursing staff and gives them more time for other tasks. Dometic medical refrigerators provide safe storage for temperature-sensitive pharmaceuticals and fast access to "daily essentials".

Product examples: DS 400, HC 302 DIN and MD 363

SURGERIES AND PHARMACIES

Dometic medical refrigerators keep temperature-sensitive pharmaceuticals, preparations and vaccines close at hand for immediate access. They provide safe storage at a temperature between +2°C and +8°C. The well organised, illuminated interior with practical drawers and compartments makes for easy handling.

Product examples: HC 302 DIN, HC 502 DIN and DS 601 H





& FOOD





DOMETIC MEDICAL REFRIGERATORS

THE MOST COMPACT MODELS

The ideal solution for storing heat-sensitive medicine safely at a temperature between +2 °C and +8 °C. Practical drawers enable you to keep the medicine organised and structured. A digital thermometer monitors the internal temperature and stores the highest and lowest temperature for a defined control period.

You can choose between two series with different cooling technologies and quality features:

HC series with powerful, energy saving compressor technology: with integrated temperature display and high-quality, roller based metal drawers (3/4 extension) with plastic front

DS series with noiseless absorption cooling: for normal ambient temperatures, fitted with an external thermometer and plastic drawers (1/2 extension) with transparent front

QUALITY FEATURES

- Constant cooling performance between +2 °C and +8 °C
- DIN certified medical refrigerators
- High-quality metal drawer with telescopic sliders
- Digital temperature display with memory function
- Audible alarm functions
- Lock included

WHY CONVENTIONAL HOUSEHOLD REFRIGERATORS WON'T WORK

Conventional household refrigerators are unsuitable for the storage of insulin, vaccines, heparin products and other heat-sensitive pharmaceuticals. Here are the main reasons why:

- Unable to maintain the required temperature between +2 °C and +8 °C
- Temperature can rise to over +10 °C during defrosting phases
- Temperature data cannot be checked and documented
- Serious health risks for patients
- Liability risks for hospitals

A medical refrigerator keeps you on the safe side.

DS SERIES MEDICAL REFRIGERATORS

NOISELESS ABSORPTION COOLING

Well proven over the last decades, DS series medical refrigerators are ideal for safe storage of insulin and other heat-sensitive pharmaceuticals at a temperature between 2°C and 8°C. The drawers allow for an organised storage of pharmaceuticals. The external digital thermometer keeps the interior temperature under control.

- Noiseless absorption cooling unit
- Fuzzy Logic technology for low power consumption
- Adjustable temperature settings for efficient usability
- LED interior light for user convenience
- Door lock for secure storage
- Drawers with flexible compartments for organized storage



Interior light



TECHNICAL DATA

MODEL	DS 301 H	DS 601 H
Storage volume (litres)	26	49
Cabinet colour	White	White
Cooling technology	Absorption	Absorption
Temperature (fixed)	5 °C	5 °C
Dimensions (H×W×D, mm)	580×422×393	592×486×494
Energy consumption (kWh/24 h)	0.86	1.05
Drawers (number)	3	3
Door lock	•	•
Digital thermometer with data memory	external	external
Variable door hinge	•	•

HC SERIES DIN MEDICAL REFRIGERATORS

EXCELLENT STORAGE CONDITIONS FOR HIGHEST DEMANDS

Medical refrigerators have to meet the very highest demands, and they have to be absolutely reliable. To be on the safe side, use equipment that complies with the DIN 58345 standard for pharmaceutical refrigerators, because it will meet the expectations for professional storage to the full extent. In addition to standard features like temperature setting, ventilated cooling and a safety

lock, our DIN certified equipment also provide a visual and audible warning function in case of temperature deviations. Thanks to an integrated battery the warning function (visual + audible) will even be maintained for at least 12 hours if the power supply fails. On top of that, DIN refrigerators are fitted with a potential free contact for alarm transmission.



Complies with DIN 58345 and Ö-Norm K2040

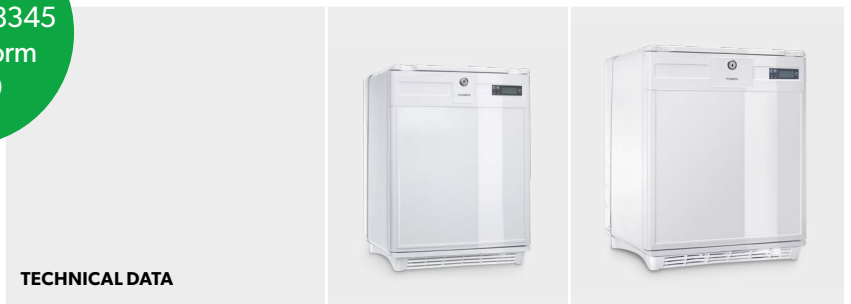

TECHNICAL DATA

MODEL	HC 302 DIN	HC 502 DIN
Cabinet colour	White	White
Cooling technology	Compressor	Compressor
Temperature (fixed)	5°C	5°C
Dimensions (H×W×D, mm)	580×422×450	592×486×494
Energy consumption (kWh/24 h)	0.42	0.44
Drawers (number)	3	3
Door lock	●	●
Digital thermometer with data memory	integrated	integrated
Variable door hinge	●/-	●/-

- Complies with DIN 58345 and Ö-Norm K2040
- Keeps heat sensitive medicine between +2°C and +8°C
- Integrated fan for reliably constant temperature
- Features an audible warning system if the door is open for more than 20 s
- Compressor cooling technology
- Convenient, robust slide-out drawers

ADDITIONAL DIN FEATURES

- Temperature variation alarm
- Power failure alarm
- External, potential free contact for alarm transmission
- AC powered display (no batteries)



Integrated in the door: illuminated thermometer min/max data memory to monitor the interior temperature



Drawers with transparent front panel



Ergonomic door handle



Interior light



Lockable door

HC SERIES MEDICAL REFRIGERATORS

NON DIN VERSIONS

Based on efficient compressor cooling, HC series medical refrigerators are amazingly powerful and energy-saving. Moreover, the models in the HC series are fitted with some useful extra features. High-quality, roller based metal drawers with 3/4 extension allow for convenient handling in everyday use, and the thermometer is integrated in the door.

- High-performance compressor cooling – even at high ambient temperatures
- Integrated in the door: illuminated thermometer min/max data memory to monitor the interior temperature
- High-quality, roller based metal drawers with 3/4 extension for well organised storage
- Door open alarm

Highly Efficient Compressor Cooling



TECHNICAL DATA

MODEL	HC 302	HC 502
Cabinet colour	White	White
Cooling technology	Compressor	Compressor
Temperature (fixed)	5°C	5°C
Dimensions (H×W×D, mm)	580×422×450	592×486×494
Energy consumption (kWh/24 h)	0.42	0.44
Drawers (number)	3	3
Door lock	•	•
Digital thermometer with data memory	integrated	integrated
Variable door hinge	•/-	•/-



Integrated thermometer



Drawers with transparent front panel



Ergonomic door handle



Interior light



Lockable door



WITH FACTORY PRESET FIXED TEMPERATURE

BREAST MILK REFRIGERATOR

Sensitive breast milk has to be stored at a temperature between +2 °C and + 4 °C to preserve its nutritional value and prevent health risks to the babies. The new MC 302 breast milk cooler provides the optimal storage conditions. A special control system ensures that the factory preset temperature of +2.5 °C is reliably maintained. The current temperature is shown on an external display – no need to open the door to check it. Additionally, any deviation from the admissible temperature range (+1 °C to +4 °C) is signalled by a warning signal.

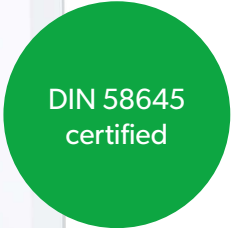



DOMETIC MC 302

Breast milk refrigerator, right hinged, 22 l

- DIN 58345 compliant
- Keeps heat-sensitive breast milk between +1 °C and +4 °C (factory preset fixed temperature of +2.5 °C)
- Door integrated with multi-functional temperature display.
- Integrated fan for reliably constant temperature
- Features an audible warning system if the door is open for more than 20 s
- Compressor cooling technology
- Convenient, robust slide-out drawers



TECHNICAL DATA

MODEL

MC 302

Storage volume (litres)	29
Cabinet colour	White
Cooling technology	Compressor
Temperature (fixed)	+2.5 °C
Dimensions (H × W × D, mm)	580 × 422 × 450
Energy consumption (kWh/24 h)	0.42
Drawers (number)	3
Door lock	●
Digital thermometer with data memory	integrated
Variable door hinge	● / -



Integrated in the door: illuminated thermometer min/max data memory to monitor the interior temperature



Drawers with transparent front panel



Ergonomic door handle



Interior light



Lockable door



COMPACT AND SILENT REFRIGERATION FOR FOOD AND MORE

SILENCIO FOOD LINE

Ideal for
Patient In Room
Comfort

Chilled drinks and food right at your fingertips at all times. When there is no room for an household refrigerator, a miniCool in the Food Line series has great benefits. Whether it's for everyday use in hospitals and nursing homes with the shortest possible distances for patients and residents or for a bit of privacy in student accommodation. The Food Line provides totally silent refrigeration without compromising on cooling performance. As the only cooling appliance in this class, the models are suitable for fresh food.

THE DOMETIC FOOD LINE MINI FRIDGE

Unique worldwide. No other noiseless refrigerator reaches an interior temperature of 4°C at up to an ambient temperature of 32°C.

IDEAL FOR:

- Nursing homes
- Hospitals
- Offices/meeting rooms
- At home as an additional refrigerator in the bedroom, living room or children's room
- Student homes/apartments



White

Built-in

Black



MODEL	DS 200 FS/BI	DS 300 FS/BI	DS 400 FS/BI	DS 600 FS/BI
Model class (litre)	20	30	40	60
Storage volume (litre)	21	27	32	43
Cabinet colour	Black or white	Black or white	Black or white	Black or white
Dimensions FS* (H x W x D, in mm)	495 x 422 x 393	580 x 422 x 393	580 x 422 x 450	592 x 486 x 494
Dimensions Built-in version** (H x W x D, in mm)	455 x 422 x 383	540 x 422 x 383	540 x 422 x 440	552 x 486 x 484
Can be built-in/integrated	●	●	●	●
Variable door hinge	●	●	●	●
LED interior light	●	●	●	●
Input rating (W)	65	65	65	65
Energy consumption (kWh/24 h)	0.74	0.76	0.76	0.77
Noise level (db[A])	0	0	0	0
Features	<ul style="list-style-type: none"> Adjustable plastic shelf with recess for tall bottles Flat inner door 	<ul style="list-style-type: none"> 2 adjustable plastic shelves with recess for tall bottles Flat inner door 	<ul style="list-style-type: none"> 2 adjustable plastic shelves 3 adjustable door racks 	<ul style="list-style-type: none"> 2 adjustable plastic shelves 3 adjustable door racks
Options	<ul style="list-style-type: none"> Sliding hinge Lock Wheels 	<ul style="list-style-type: none"> Sliding hinge Lock Wheels 	<ul style="list-style-type: none"> Sliding hinge Lock Wheels 	<ul style="list-style-type: none"> Sliding hinge Lock Wheels

*FS version: with foot frame, door decor panel and back cover, ** BI version: for fully-integrated installation (with sliding hinge, without exterior ABS plastic cabinet, door panel and foot frame) Please note our ventilation tips for built-in refrigerators (p. 16).



DS 200 FS/BI



DS 300 FS/BI



DS 400 FS/BI



DS 600 FS/BI



EASY CUSTOMIZING WITH BI MODELS

Designed for built-in use: BI mini fridges are fitted in the factory with a sliding hinge to be fastened to the furniture door to compensate for the differing turning points between the furniture and fridge door. That means the refrigerators can be easily fitted with a front panel to suit your interior design concept.

INSTALLATION TIPS FOR BUILT-IN REFRIGERATORS



THINGS TO NOTE WHEN INSTALLING A BUILT-IN ABSORPTION REFRIGERATOR

- The refrigerator must be placed on a surface that is level in both directions
- There should be 2 cm clearance to the wall
- Ventilation must be provided as shown in the drawings below (A, B, C or D)
- The ventilation duct must at least measure 105 mm x the width of the refrigerator
- The entire cooling unit should protrude into the ventilation duct as shown
- Air passing through the duct must not be warmed up by any source of heat
- Ventilation grills, if used, must have a free opening of at least 200 cm² each

Dometic absorption fridges are equipped with an electrically heated cooling unit which is virtually silent in operation. The heat which the cooling unit extracts from the refrigerator interior is emitted at the back of the fridge. If you have a free-standing model, sufficient ventilation is provided in most cases. If you want to integrate the fridge into a piece of furniture, however, the following instructions need to met.

Please note that there must be sufficient room for ventilation behind the refrigerator to prevent heat build-up. As a rule of thumb, the free ventilation space should be at least 300 cm² for incoming air and at least 200 cm² for outgoing air. The distance from the rear of the refrigerator to the rear wall of the furniture must be at least 2 cm. During installation, make sure that the refrigerator is standing on a stable, level surface, and not directly near a heat source.

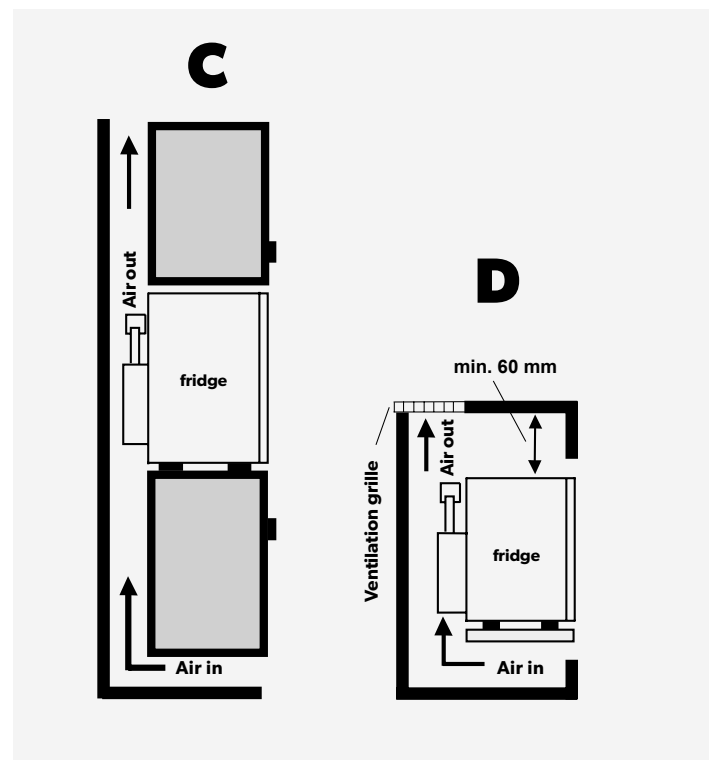
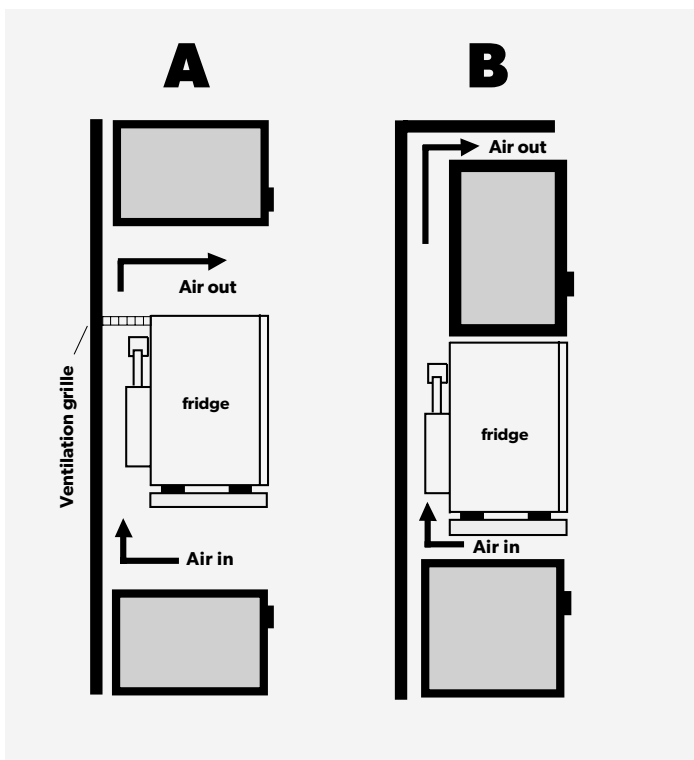

COOLFREEZE CFX COMPRESSOR COOLERS

RELIABLE COOLING AND DEEP-FREEZING DOWN TO -22°C

Excellent cooling and freezing performance, low energy consumption – features you can depend on with each compressor appliance from Dometic. CoolFreeze CFX series coolers are perfectly equipped for safe transport of sensitive food in hospitals and nursing homes. Featuring a specially developed, high-performance compressor and an extra-strong insulation, they consume up to 35% less energy than comparable units.

Fitted with heavy-duty features like reinforced corners, stainless steel hinges and a robust lid lining, the high-tech coolers in the CFX series can withstand the most demanding of loads. Even so, they are remarkably lightweight and easy to transport. All models in the CFX professional series give you the convenient option of controlling and monitoring the cooling temperature by WiFi app.

TEMPERATURE CONTROL VIA WIFI APP

All CoolFreeze CFX coolers can be conveniently controlled by smartphone. Our WiFi app provides plenty of options. You can set different cooling temperatures, battery protection levels and temperature alarms. Or switch the cooler on and off from a distance.

- ON/OFF switch
- Temperature setting via slider or button
- Programming of battery protection levels and temperature alarms
- Display of current temperature, energy source, voltage and warning messages
- Android and iOS version available

- Suitable for deep freezing down to -22°C
- Excellent cooling performance even at extremely high outside temperatures
- 12/24 volts DC and 100 – 240 volts AC
- CFX special electronics with digital temperature display
- Extremely efficient and superbly quiet operation
- USB port for charging low-power electronic devices
- Drain plugs make cleaning simple
- Suitable for solar operation
- Heavy-duty design
- Temperature control by WiFi app



CONTROLLED
VIA WIFI APP



12/24 V



100-240 V



SOLAR
OPERATION



ENERGY CLASS

For the complete CFX range please visit dometic.com



LED light – energy-efficient LED interior light



Connectivity USB port for charging small electronic devices



Quick overview – electronic thermostat with digital temperature display



Temperature control via WiFi app